

F3240







Superior Efficiency

Rivulis F3240 Automatic Screen Filters (Hydraulic)

- **Efficient:** Fully automated operation with small foot print, minimal water used for backflush, no external power source required
- **Dual barrier corrosion protection:** Epoxy lined with additional exterior polyester coating
- **Large filtration area:** Featuring one of the largest relative screen areas on the market
- **Ideal as primary filtration with automatic cleaning** (no mains power source required)

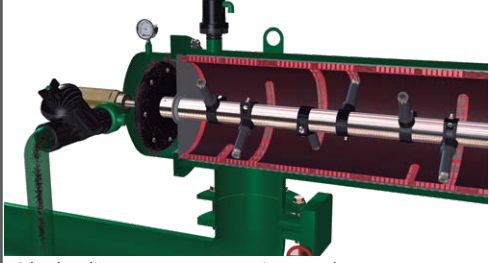
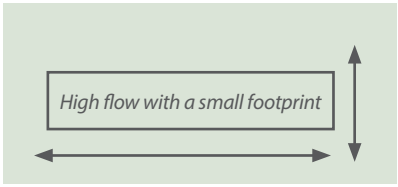
The Most Efficient Way to Protect Your Irrigation System

Farming economics 101 is about efficiency. The more you save, the more you profit. The Rivulis F3240 delivers greater efficiency to your overall system while protecting your irrigation equipment from contaminants.

<p>Efficient clean</p> <p>Fully automatic operation. The filter automatically cleans itself both by detection of pressure differential and at timed intervals. No need for manual flushing and associated labor</p>	 <p><i>A hydraulic motor rotates suction nozzles to automatically clean the filter screen</i></p>
<p>Efficient footprint</p> <p>In a space just the size of 2m x 1m, you can filter 300 cubic meters of water per hour</p>	
<p>Efficient cleaning</p> <p>The Rivulis F3240 features heavy duty brushes that allow closer cleaning against the screen. The result – backflush suction force is maximized, in turn delivering maximum cleaning efficiency.</p>	
<p>Efficient backflush</p> <p>Minimal water is used during the backflush process - as low as 5 liters is consumed per flush (2" angle model). The average water requirement for flushing can be found in the performance data tables</p>	 <p><i>The backflush valves is opened to release the minimal amount of water required</i></p>
<p>Efficient operation</p> <p>Each filter includes an easy to use Rivulis flush controller, industrial solenoids, and a Rivulis air valve for efficient operation. Parallel models feature an easy to open end-port for easy maintenance</p>	

Dual Barrier Protection

Rust corrosion can significantly reduce your filter life.

All Rivulis F3240 filters are designed with dual barrier protection. An external polyester coated layer and internal epoxy coating inside the filter. Epoxy reacts by bonding with the metal itself to provide a hard, robust surface - one of the most effective methods of preventing metal from corrosion.

Compare this to other screen filters on the market, which provide limited protection against rust. Some only apply an internal polyester coating that primarily provides UV protection, but as it is inside the filter, it is not much help as the UV rays only effect the outside of the filter.

Polyester Coated

For environmental and UV protection

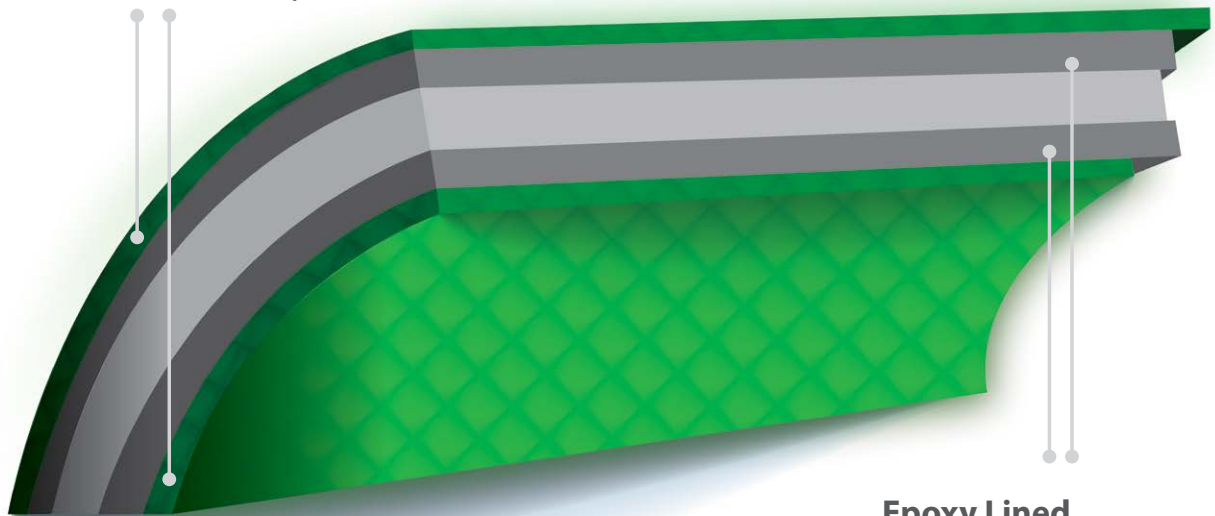

Epoxy Lined

For corrosion protection

Rivulis F3240 - best protection with dual epoxy-polyester barriers.



Epoxy coating helps prevent rust corrosion that reduces the life of most metal filters.

Larger Screen Area

The Rivulis F3240 features the largest screen area on the market offering the following benefits:

- Higher maximum flow capacity in the same diameter filter
- Longer intervals between backflushes and less wear on the filter

The Rivulis F3240 features the largest screen area compared to major competitors as shown in the graph below.

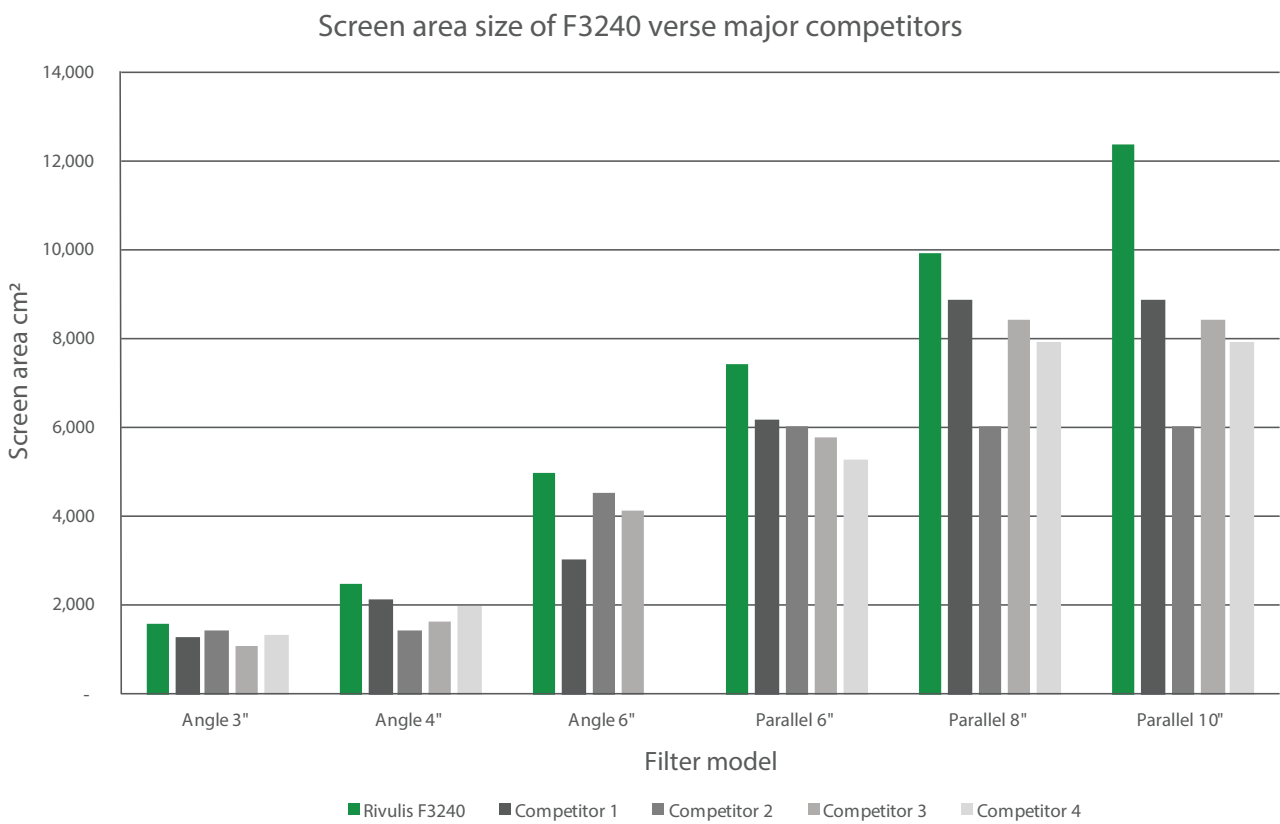

Rivulis F3240 Automatic Screen Filter | Angle

Product Information	
Body style:	Angle (compact)
Screen options	100, 130 microns (other options available)
Molded stainless steel screen standard	
Current options	AC or DC controlled

Key Operating Guidelines	
Maximum working pressure	8.0 bar
Maximum pressure	10.0 bar
Minimum flushing pressure	2.0 bar



Rivulis F3240 Angle | Summary

Inlet / Outlet		Body	Connections	Maximum Flow Rate	Flush Flow Rate Range	Screen Area	Screens	Current Options
inch	mm			m ³ /h	l/flushing	PVC screen m ³ /h	micron	
2	50	Angle	BSP	25	5	910	100, 130	DC
3	80	Angle	ISO 16	50	12.5	1600	100, 130	DC
4	100	Angle	ISO 16	80	15.5	2400	100, 130	DC
6	150	Angle	ISO 16	150	53	4800	100, 130	DC

* Consult with your Rivulis representative for other filtration levels and connections

Product Head Loss Chart (bar)

Inlet / Outlet		Flow Rate (m ³ /h)								
		15	25	50	75	100	150	200	250	300
inch	mm	Head Loss (bar)								
2	50	0.02	0.06	0.35	0.80					
3	80			0.07	0.17	0.35	0.70			
4	100			0.012	0.06	0.11	0.25	0.50		
6	150				0.012	0.03	0.07	0.17	0.25	0.40

Rivulis F3240 | Angle

Product Dimensions and Weights

Size	DN	A	B	C	D	Weight
inch	mm	mm	mm	mm	mm	kg
2	50	220	220	600	480	35
3	80	220	250	690	480	45
4	100	260	320	800	570	60
6	150	260	470	1075	570	81

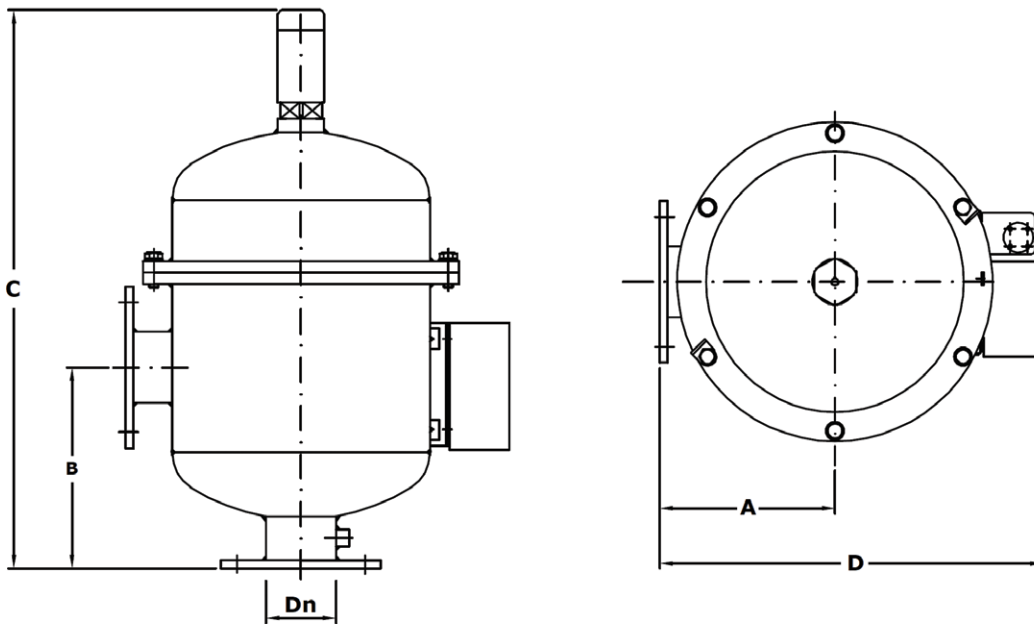

Rivulis F3240 Automatic Screen Filter | Parallel

Product Information	
Body style:	Parallel
Screen options	100, 130 microns (other options available)
Molded screen standard / Sintered screen optional	
Current options	AC or DC controlled



Key Operating Guidelines	
Maximum working pressure	8.0 bar
Maximum pressure	10.0 bar
Minimum flushing pressure steel screen standard	2.0 bar

Rivulis F3240 Parallel | Summary

Inlet / Outlet		Body	Connections	Maximum Flow Rate	Flush Flow Rate Range	Screen Area	Screens	Current Options
inch	mm			m ³ /h	l/flushing	PVC screen m ³ /h	micron	
3	80	Parallel	ISO 16	60	25	2450	100, 130	DC
4	100	Parallel	ISO 16	80	49	4800	100, 130	DC
6	150	Parallel	ISO 16	160	110	7200	100, 130	DC
8	200	Parallel	ISO 16	300	178	9600	100, 130	DC
10	250	Parallel	ISO 16	400	238	12000	100, 130	DC

* Consult with your Rivulis representative for other filtration levels and connections

Product Head Loss Chart (bar)

Inlet / Outlet		Flow Rate (m ³ /h)									
		15	25	50	75	100	150	200	300	400	500
inch	mm	Head Loss (bar)									
3	80		0.02	0.07	0.15	0.25	0.43				
4	100			0.03	0.05	0.10	0.20	0.35	0.65		
6	150				0.03	0.05	0.10	0.18	0.33	0.68	
8	200					0.03	0.06	0.10	0.20	0.40	0.60
10	250						0.03	0.05	0.10	0.20	0.25

Rivulis F3240 | Parallel

Product Dimensions and Weights

Size	DN	A	B	C	E	F	G	Weight
inch	mm	mm	mm	mm	mm	mm	mm	kg
3	80	156	360	196	712	500	1202	100
4	100	111	770	106	987	690	1477	115
6	150	181	900	181	1262	970	1752	130
8	200	231	1100	206	1537	1240	2027	145
10	250	231	1370	211	1812	1520	2302	165

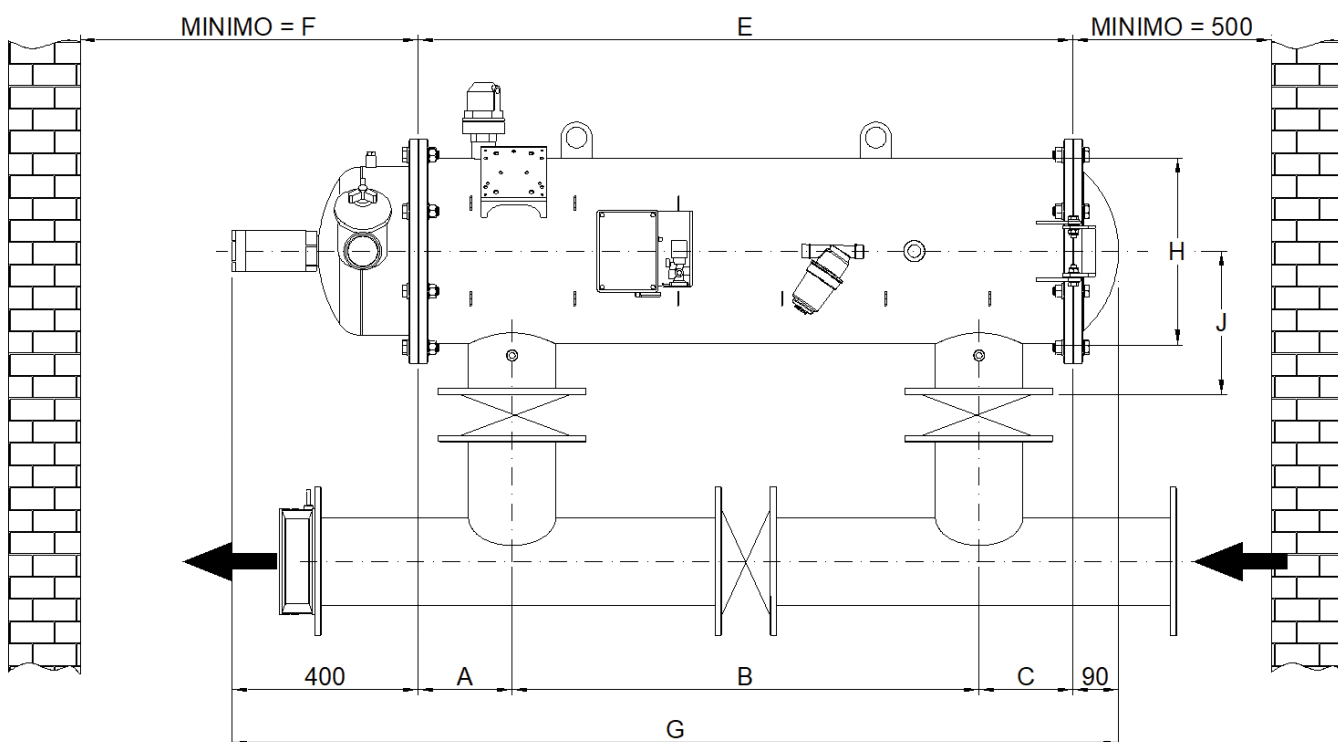

Product List

Rivulis F3240							
Product Description	Body Style	Inlet/Outlet Size		Connection Type	Screen*	Screen Rating (micron)	Product Number
		(inch)	(mm)				
F3240 (Angle) - 2 inch (50 mm) - 130 micron	Angle	2	50	BSP	PVC	130	101050564
F3240 (Angle) - 2 inch (50 mm) - 100 micron		2	50			100	101050565
F3240 (Angle) - 3 inch (80 mm) - 130 micron		3	80	130		101050566	
F3240 (Angle) - 3 inch (80 mm) - 100 micron		3	80			101050567	
F3240 (Angle) - 4 inch (100 mm) - 130 micron		4	100	130	101050568		
F3240 (Angle) - 4 inch (100 mm) - 100 micron		4	100		101050569		
F3240 (Angle) - 6 inch (150 mm) - 130 micron		6	150	130	101050570		
F3240 (Angle) - 6 inch (150 mm) - 100 micron		6	150		101050571		
F3240 (Parallel) - 3 inch (80 mm) - 130 micron	Parallel	3	80	ISO 16	Molded	130	101050572
F3240 (Parallel) - 3 inch (80 mm) - 100 micron		3	80			100	101050573
F3240 (Parallel) - 4 inch (100 mm) - 130 micron		4	100			130	101050574
F3240 (Parallel) - 4 inch (100 mm) - 100 micron		4	100				101050575
F3240 (Parallel) - 6 inch (150 mm) - 130 micron		6	150	130		101050576	
F3240 (Parallel) - 6 inch (150 mm) - 100 micron		6	150		101050577		
F3240 (Parallel) - 8 inch (200 mm) - 130 micron		8	200	130	101050578		
F3240 (Parallel) - 8 inch (200 mm) - 100 micron		8	200		101050457		
F3240 (Parallel) - 10 inch (250 mm) - 130 micron		10	250	130	101050579		
F3240 (Parallel) - 10 inch (250 mm) - 100 micron		10	250		101050580		



Other options available: (1) Sintered Screen, (2) AC / DC / without controller, (3) other maximum pressures, (4) other filtration levels and (5) other connections

F3240



Case study outcomes are for information purposes only and actual results may vary. This literature has been compiled for worldwide circulation and the descriptions, photos, and information are for general purpose use only. Please consult with an irrigation specialist and technical specifications for proper use of Rivulis products. Because some products are not available in all regions, please contact your local dealer for details. Rivulis reserves the right to change specifications and the design of all products without notice. Every effort has been used to ensure that product information, including data sheets, schematics, manuals and brochures are correct. However information should be verified before making any decisions based on this information.